

SPECIFICATION SHEET

Product Code **P**

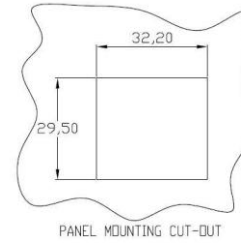

PANEL MOUNTING CUT-OUT

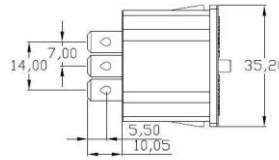
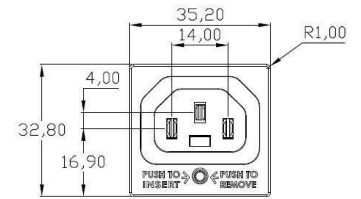
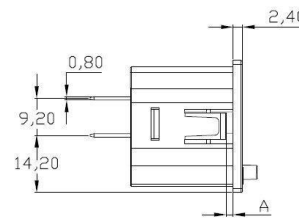
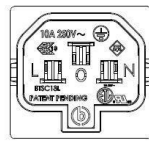

General Information		
Features	Snap-in mounting from front. Solder terminal or quick connect from single terminal. Protection class 1. Integral plug retention feature.	
Technical Data		
Rating	10A/250VAC	
Insulation Resistance	10MΩ (500VDC, 1 Min.)	
Dielectric Strength	2KV (50Hz 1 Min) to accessible surfaces	
Materials	Socket: Black Thermoplastic UL94V-0	
Patent		
UK Number	2463468B	
EU Number	EP2321879A	
HK Number	HK1141901	
Chinese Patent Application Number	CN 102150330 A	
Products		
Part Reference Number	Description	Terminal Type
	Black IEC320 C13 Snap in 1mm Panel Thickness	Quick Connector/Solder 6.3 x 0.8mm
	Black IEC320 C13 Snap in 1.5mm Panel Thickness	Quick Connector/Solder 6.3 x 0.8mm
	White IEC320 C13 Snap in 1mm Panel Thickness	Quick Connector/Solder 6.3 x 0.8mm
	White IEC320 C13 Snap in 1.5mm Panel Thickness	Quick Connector/Solder 6.3 x 0.8mm
Other Information		
Standards	IEC/EN 60320-2-2/F UL498 CSA C22.2 No 182.3-M1987	
Approvals	10 A/250VAC 15 A/250VAC	

